

## Guest internet (WLAN)

Dear patients,  
Dear visitors

We are very pleased to provide you with wireless internet access (WLAN). The guest internet is a free service that you can use on your private notebook, tablet or smartphone. For the following instructions you need a mobile phone.

### Instructions

1. Connect your device to the WLAN network “unispital-public”.

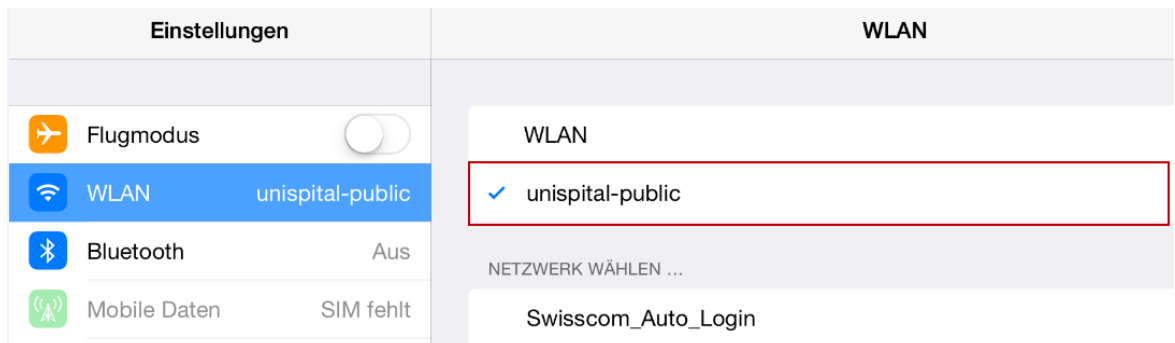

2. Open your browser (e.g. Internet Explorer, Firefox, Safari, Google Chrome) and enter the address “guest.usz.ch”. The welcome page will be shown.
3. Click on “Ask for login credentials via SMS” below Patients and Guests to continue with the SMS verification.

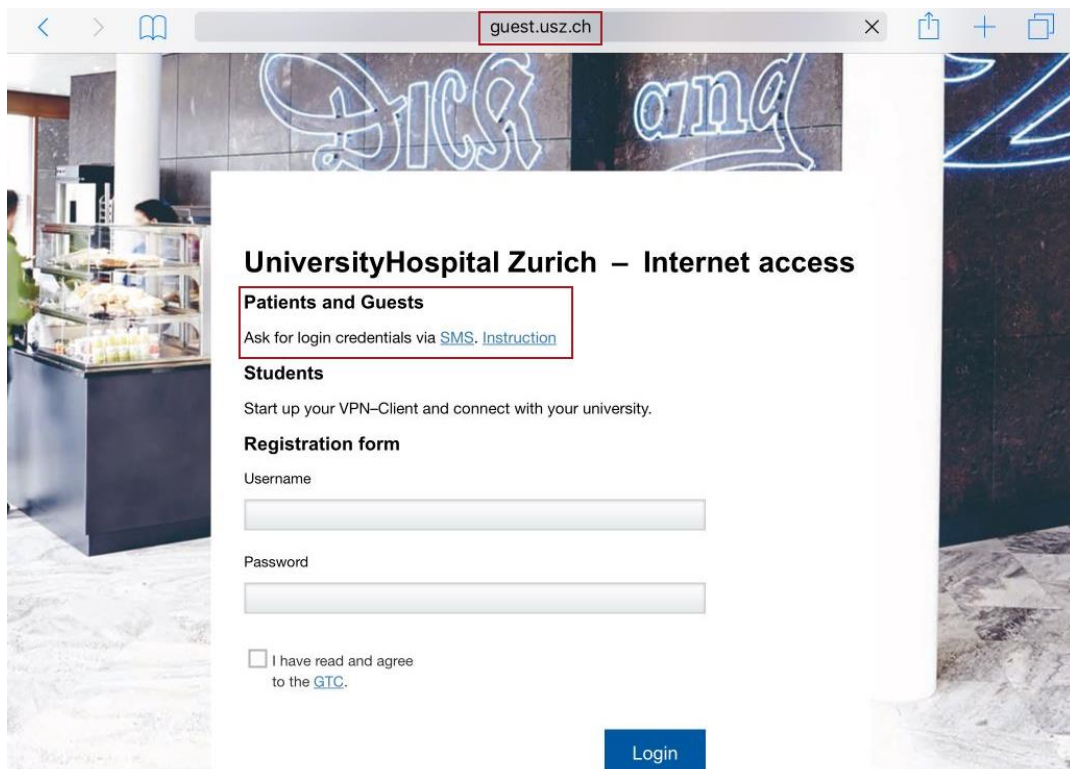

4. Read the conditions of use (GTC) and confirm them with a tick. Then enter your mobile phone number and press "request access code".

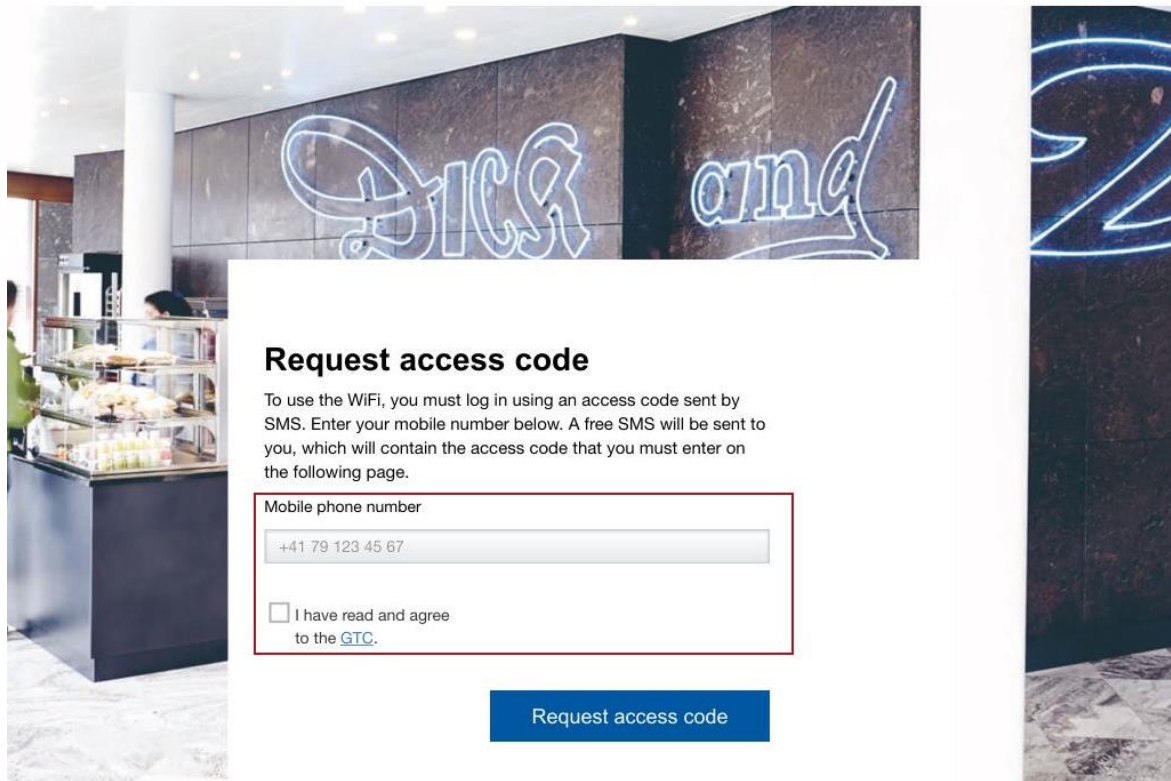

5. You will receive a text with your code shortly.

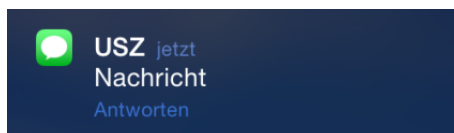

6. Enter the code and then click on “submit registration”.

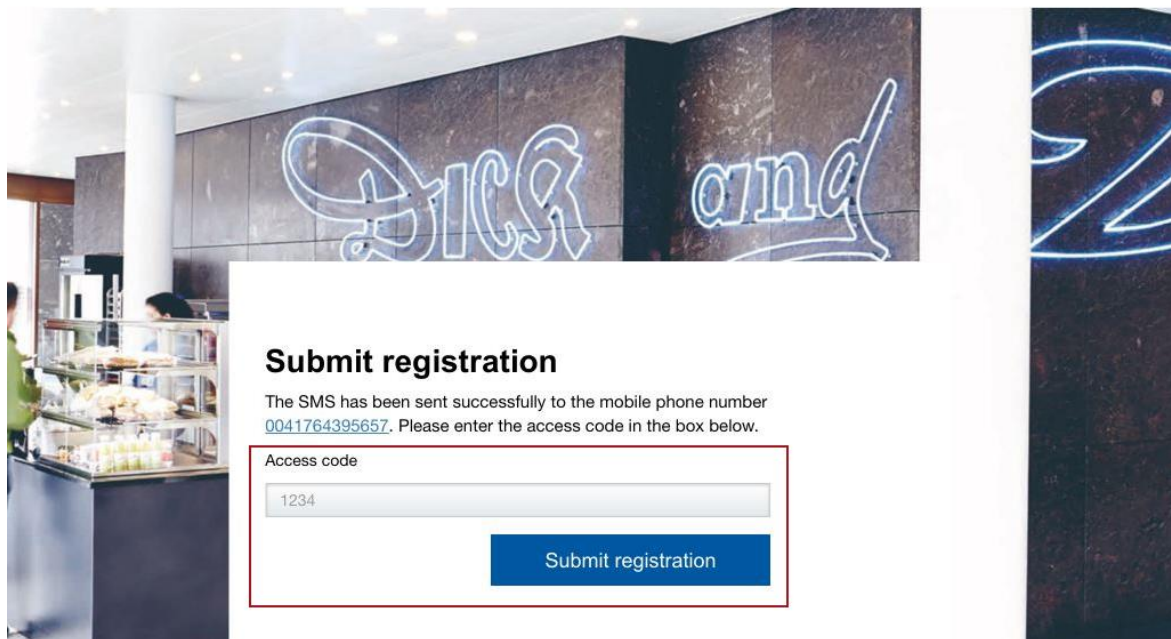

7. On successful login, the main page “www.usz.ch” will be shown.

### General Information

#### *Logging out of the guest internet:*

- After successful login, you will remain logged in with your device for 30 days, afterward your device will log off automatically.

#### *If you are being treated at the UniversitätsSpital Zurich for longer than 30 days:*

- Your account will expire after 30 days, then you must re-register (see procedure under instructions).

### Frequently asked questions

#### *No network was found:*

- With some notebooks, the wireless function must be switched on with a mechanical switch.
- Click on “wireless network connection” with the right mouse button, select “deactivate”. Repeat the process and select “activate” and then “create connection”.

#### *The “wireless network connections” icon is missing:*

- It is possible that your notebook has no built in WLAN function or the required settings have not been configured. Please ask a computer literate acquaintance to help you if necessary.

#### *No choice of network appears (instructions point 1):*

- If your device automatically connects to the “open” network “unispital-public”, continue with point 2 in the instructions.